



## Customer Countertop Project Estimation Worksheet

This worksheet will help you build a preliminary measurement for your countertop project and will help you obtain an estimate of your project. The price of your project will vary based on surface type, color group, edge profile, and additional design options.

**For Retail Jobs:** A precise cost will be calculated after one of our template technicians completes a full template of your project and compiles a list of your options.

**For Remnant Sales:** Your price will be estimated at the time of the sale and you will be responsible for the measure of your own job.

**Customer Name:** \_\_\_\_\_ **Phone:** \_\_\_\_\_

### Drawing:

In the grid below, draw a representation of your countertop(s). Section your drawing into simple rectangles and squares, and labeling them as separate sections, as needed. Please include/notate any bar tops, backsplashes, islands, or even peninsulas.

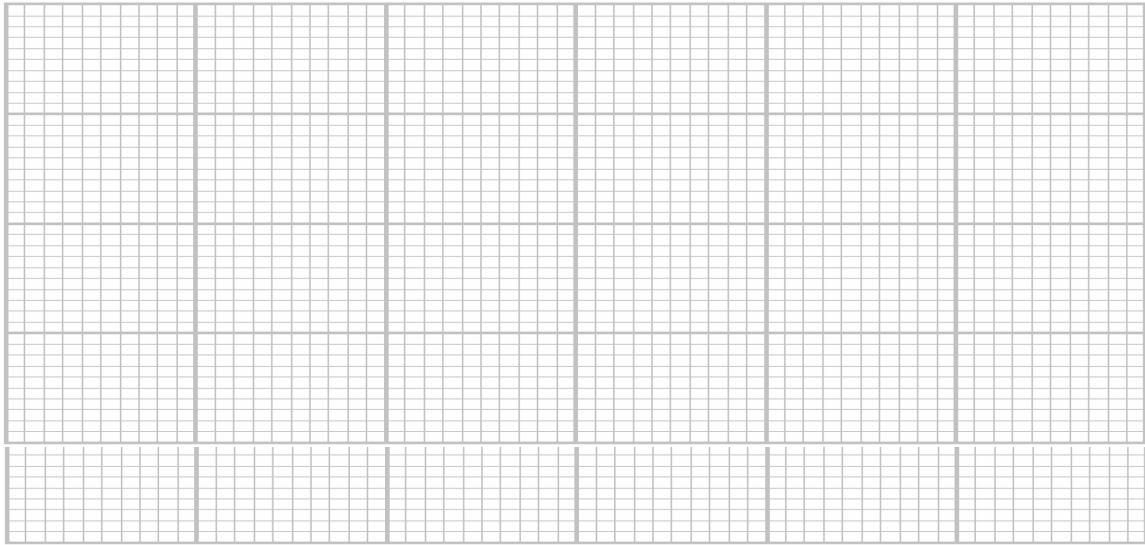

### Inspiration: Examples of Kitchen Layouts

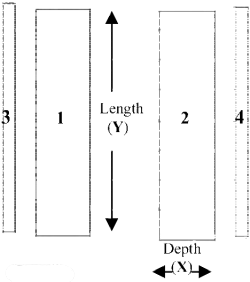

**Standard**

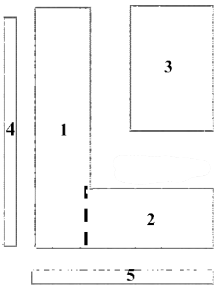

**L-Shape**

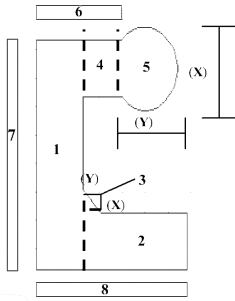

**U-Shape**



## Customer Countertop Project Estimation Worksheet

### Keep In Mind:

If your measure will include a sink, you will need to measure your **Sink Center**. To do this, take the center of the SINK BASE cabinet (length wise), mark it, and then measure from the closest wall to that center mark. For verification, make sure your markup matches the center of the sink base cabinet doors. This will provide you with the sink center.

If your project includes Backsplash, please note (on your drawing) what will be considered a **WALL** and what will be considered **BACKSPLASH**. Be sure to define how tall you will like your backsplash to be.

**WATCH OUT:**  
When defining your sink center, please ensure you are measuring from the wall and **NOT** from the backsplash.

### Math:

Here, you will compute your square footage.

- Measure each countertop section and record the length and depth, dimensions of the sections (in inches, rounded to the nearest inch).
- Compute the area of each section.
- Add all the sections (1-8) together to calculate to the total square inches.
- Divide the total square inches by 144 to get the total square feet.

Once complete, estimate your countertop price by multiplying the total square feet by the Square Foot Retail Price.

**Give us a call if you have any questions or need assistance.**

Countertop Sections				
Length"	x	Depth"	=	Area
1	x		=	
2	x		=	
3	x		=	
4	x		=	
5	x		=	
6	x		=	
7	x		=	
8	x		=	
Total Square Inches:				
				÷ 144
= Total Square Feet:				
x Square Foot Retail Price: \$				
= Estimated Basic Price: \$				

**DON'T FORGET TO TAKE AND BRING PICTURES OF YOUR CABINETS, WALLS, AND MEASURED AREA!**